

BUICK



Buick Reception Back Wall Assembly Instructions

Instructions:

1. The baseplates and pillar assemblies must be assembled before mounting them to the floor (items one and two).
2. Locate on the floor the center point of where the back wall is to be positioned. Measure 28-3/16" in both directions to determine the location of the innermost point of the baseplates (total distance between plates should be 56-3/8").
3. Using a pencil, mark the location of the holes of **one** baseplate.
4. Slide baseplate/pillar assembly out of position to allow the previously marked hole locations to be drilled.
5. Drill 3/8" diameter holes into floor and clean out dust particles.
6. Hammer the provided anchor into the hole with nut in place to protect threads.
7. Remove nut and save for later use.
8. Repeat for remaining holes.
9. Mount the baseplate/pillar assembly using provided hardware.
10. Carefully slide the center panel into the previously installed baseplate/pillar assembly.
11. Lift the opposite end of the center panel and carefully slide the second baseplate/pillar assembly into position. **Do not fasten the second baseplate/pillar assembly to floor.**
12. Using supplied screws, attach the header tube weldments to the header.
13. Slide header into position, moving the second baseplate/pillar assembly as required. Install the header tube lock brackets. **Do not install screws.**
14. Using a pencil, mark the position of the holes of the second baseplate/pillar assembly.
15. Remove header.
16. Stabilize center panel and slide second baseplate/pillar assembly out of position to allow the previously marked hole locations to be drilled.
17. Follow steps 5-8 to fasten second baseplate/pillar assembly to floor.
18. Lift the center panel and carefully lift the remaining baseplate/pillar assembly into position.
19. Mount second baseplate/pillar assembly using provided hardware.
20. Slide header into position. Install the header tube lock brackets and secure using provided hardware.

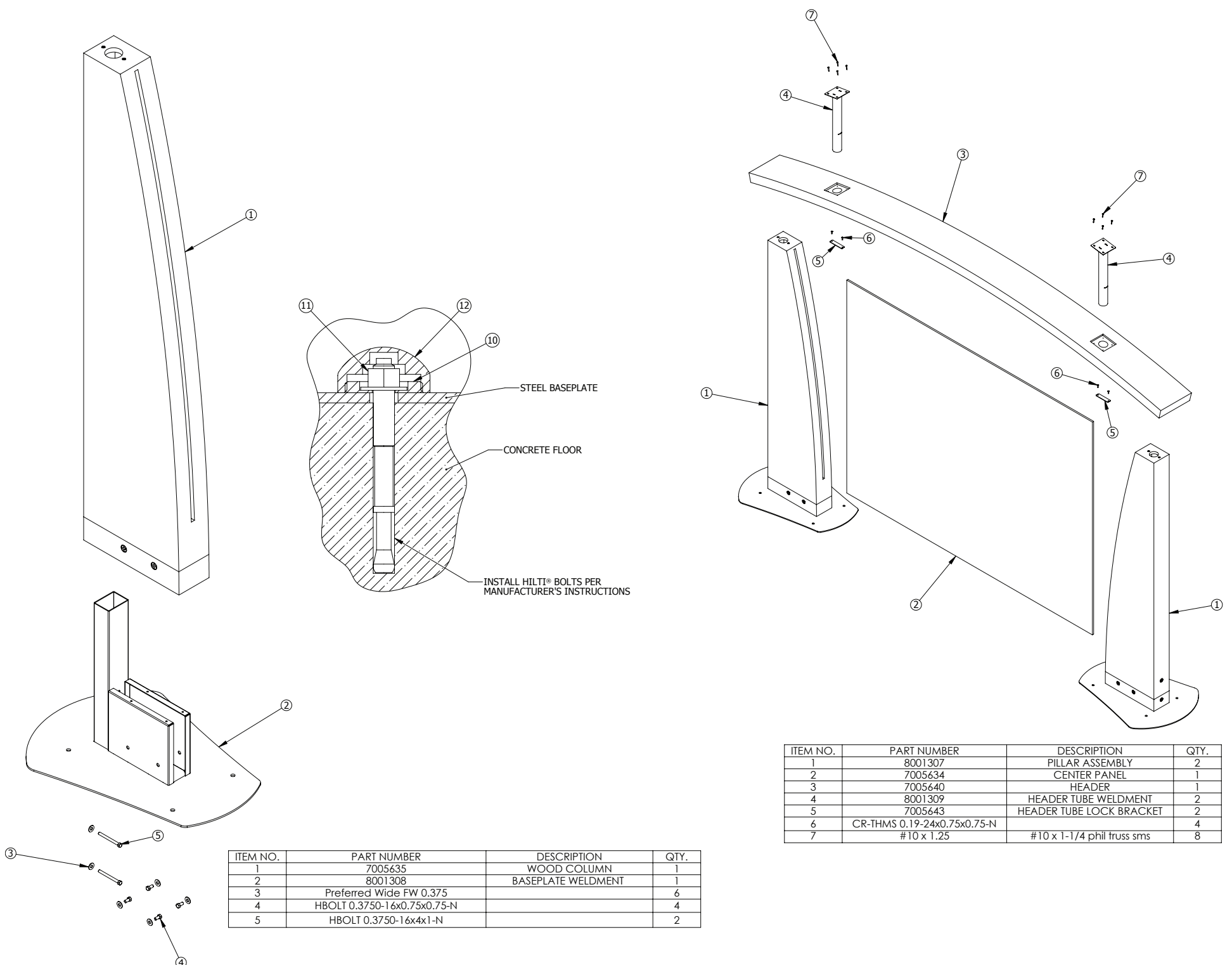

ITEM NO.	PART NUMBER	DESCRIPTION	QTY.
1	7005635	WOOD COLUMN	1
2	8001308	BASEPLATE WELDMENT	1
3	Preferred Wide FW 0.375		6
4	HBOLT 0.3750-16x0.75x0.75-N		4
5	HBOLT 0.3750-16x4x1-N		2

ITEM NO.	PART NUMBER	DESCRIPTION	QTY.
1	8001307	PILLAR ASSEMBLY	2
2	7005634	CENTER PANEL	1
3	7005640	HEADER	1
4	8001309	HEADER TUBE WELDMENT	2
5	7005643	HEADER TUBE LOCK BRACKET	2
6	CR-THMS 0.19-24x0.75x0.75-N		4
7	#10 x 1.25	#10 x 1-1/4 phil truss sms	8

If you have any questions, please call Program Headquarters at 1-800-766-5660.